



1. INTRODUCTION
2. HOTEL HISTORY
3. GUEST ROOMS
4. SUITES
5. DIANA GARDEN BAR & RESTAURANT
6. GREEN OASIS
7. EVENTS
8. CAPACITY CHART
9. FLOOR PLANS
10. WEDDING
11. EXPLORE MILAN
12. HOTEL INFORMATION

---

The Garden  
of Milan

---



Your journey  
begins here.  
Experience the  
Milanese lifestyle  
first hand



The Sheraton Diana Majestic is an historical hotel located in the heartbeat of Milan. The Diana, in its splendid Liberty beauty, is a mix of tradition and innovation that never lost its unique charm. It has always been a popular reference point and a city Belle Époque styled oasis for the business and fashion travelers seeking a glamorous and vibrant location for their stay.

# Hotel History

More than 100  
years of history



The history starts in 1842 when the first public swimming pool was opened, the "Diana Bath". In 1908 "The Kursaal" was born as a new recreational complex, that soon became a crucial meeting point for the Milanese high society. In 1921 the name of the Kursaal Diana made history due to a tragic event: a bomb exploded during a theatrical performance. The Kursaal will ultimately recover in its majestic beauty throughout the following years being acknowledged, later on, as the high fashion hotel where new trends come to life.



## Guest Rooms

Allow yourself a memorable stay in Milan

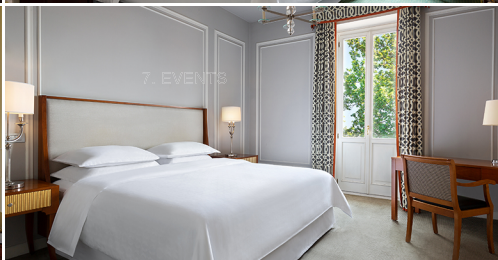

7. EVENTS

At Diana you can breathe the same old authentic charm that lends the hotel an alluring and somehow nostalgic aura. The 106 rooms and suites, in their retro cozy style, are the perfect manifestation of this vibe. The sublimely comfortable rooms, designed to deliver an unforgettable stay experience, are decorated to reflect the flair and grace of the Empire style. Many of them boast a spectacular view on the hotel's lush private garden that will grant you a heavenly escape from the city's chaotic rhythm.



## Junior Suite



## Deluxe Suite



Get the most out of your stay and opt for one of our suites to fully enjoy your visit in the capital of fashion. The spaces are designed to relax and entertain friends or colleagues in their 30's inspired ambience. Our 95sqm Deluxe Suite is the choice for ultimate comfort and privacy thanks to wide light-filled spaces and separate living area.



# Diana Garden

Bar & Restaurant



# Green Oasis

The Garden of  
Breath

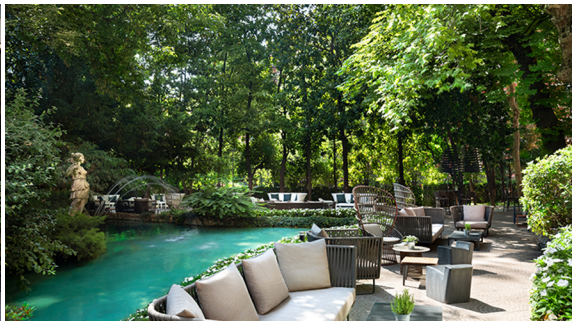

The Diana Garden Bar & Restaurant has an impressive bow window overlooking our blooming green oasis of unparalleled beauty. This secret and peaceful shelter right in the heart of the city will soon make you forget you are still in Milan, taking you into a world of enchantment, perfect frame of your best gatherings.



# Events

Iconic spaces for  
memorable events



Discover our elegant and functional collection of spaces for events. Thanks to the versatility of their fittings, our venues can be the setting for fashion shows, product presentations, private parties and ground-breaking meetings. Our team can provide you the right spaces and services, including the latest technical equipment and free Wi-Fi, to help you find the option most suited to your needs. All our rooms are exposed to natural light and allow to extend the event open-air to our garden and outdoors.



# Capacity Chart

	Length x Width <i>Lunghezza x Larghezza</i>	Height <i>Altezza</i>	Area	Natural light <i>Luce naturale</i>	Max Cap.	Boardroom <i>Tavolo unico</i>	U-shape <i>Ferro di cavallo</i>	Theater <i>Platea</i>	Cabaret	Classroom <i>Banchi scuola</i>	Banquet <i>Banchetto</i>	Reception <i>Cocktail</i>
<b>DIANA ROOM</b>	12 x 9 m 39 x 29.5 ft	4.8m 15.7ft	108 m <sup>2</sup> 1162 ft <sup>2</sup>	Y	100	35	35	70	40	24	100	100
<b>VENEZIA ROOM</b>	18 x 5.8 m 59 x 19 ft	3.6m 11.8ft	105 m <sup>2</sup> 1130 ft <sup>2</sup>	Y	120	40	40	120	50	60	90	120
<b>GIARDINO</b>	14.1 x 3.6 m 46.3 x 11.8 ft	3.6m 11.8ft	51 m <sup>2</sup> 549 ft <sup>2</sup>	Y	35	25	15	30	-	12	-	35

## OUTDOOR SPACES

<b>DRAGONE</b>				Y	150							
<b>GLICINE</b>				Y	150							
<b>TERRAZZA</b>				Y	130							

## Floor Plans

Lobby Level

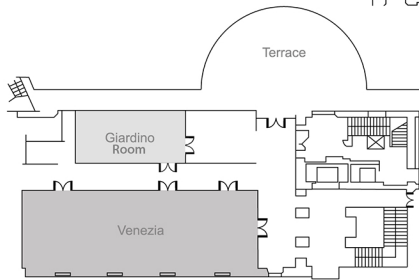
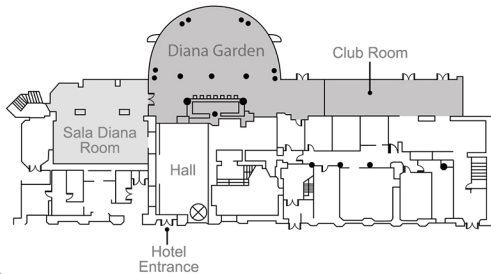

First Floor

# Wedding

Make your dream  
come true in a perfect  
romantic setting



The Diana is the perfect romantic setting for wedding day celebrations thanks to its stylish and beautiful venues. Our experienced in-house events team will support you in the organization of your special day with a customized set up and menu. Moreover, our wedding specialist will be pleased to assist you to make arrangements with our exclusive floral designer.

## Explore Milan

Experience the city's  
creative energy



Benefit of the comfort of our hotel but don't forget to discover the city! The precious consultancy of our Concierge Team will guide you in exploring the city, providing you with useful recommendation and advices to discover the captivating charm and style of the precious hidden gems of Milan and its surroundings.



## Hotel Information

### LOCATION & CONTACTS

Viale Piave 42, Milan, 20129

City attractions walking distance from the hotel

Outdoor markets, clubs, art galleries, and theatres nearby

Milan's two airports are close by: Linate - 15 min, Malpensa - 50 min

+39 02 20581 | [sheraton.diana.majestic@marriott.com](mailto:sheraton.diana.majestic@marriott.com)

### GUEST ROOMS

106 charming guest rooms including 11 suites

Luminous and stylish guest rooms with a unique view over the hotel's iconic private garden

### RESTAURANTS AND BARS

Diana Garden Bar & Restaurant

### MEETINGS AND BUSINESS

3 venues for meetings and private events

Total available space of 1.000 sqm

The private garden, a hidden treasure in the heart of Milan, offers a surprising location for cocktails and private receptions

### LEISURE

Sheraton Fitness room

Terrace and Garden

The place to be for the most glamorous aperitif in town

